

Weather Fin and bulb help keep bad weather outside and good air inside

Windows:

■ Many light kits are available

1-LU 4 X 48 1-LE 16 X 16 1-LA 20 X 24
1-LI 20 X 24 1-B 22 X 36 1-LW 16 X 16 W/GRID
9-LB 22 X 36 W/GRIDS



PLYCO Series 95 Utility Door

We have incorporated:

- Universal swing feature, and is fully reversible in the 3 1/2" thick jamb
- Polyurethane Foam Core which reduces sound and possesses superior insulating qualities, R-13
- Three 4 x 4 butt hinges per door - prevents wracking and assures smooth positive operation
- Heavy duty 16 gauge steel frame
- Full perimeter weather stripping.
- Variety of locks, hardware and windows available (optional)

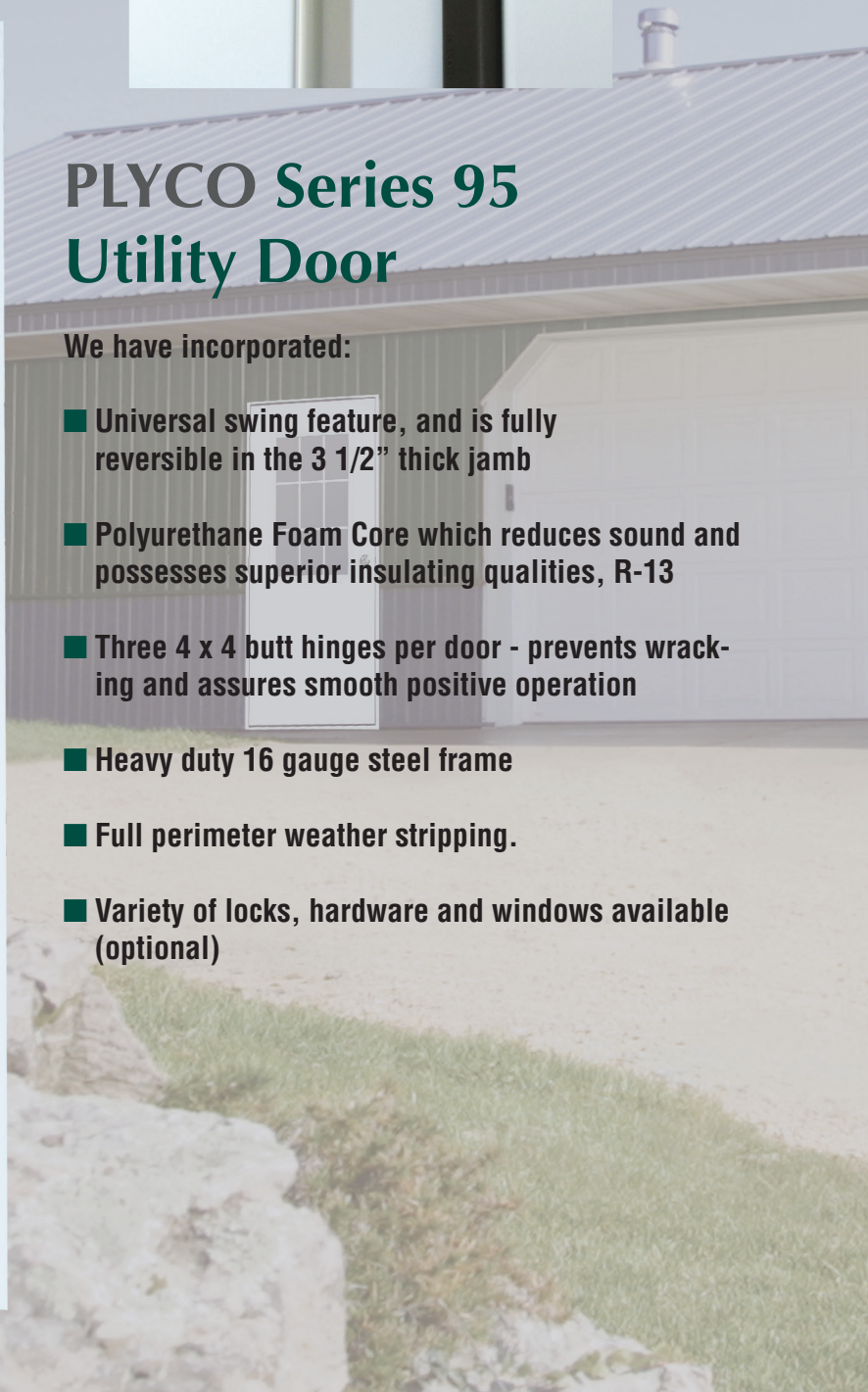

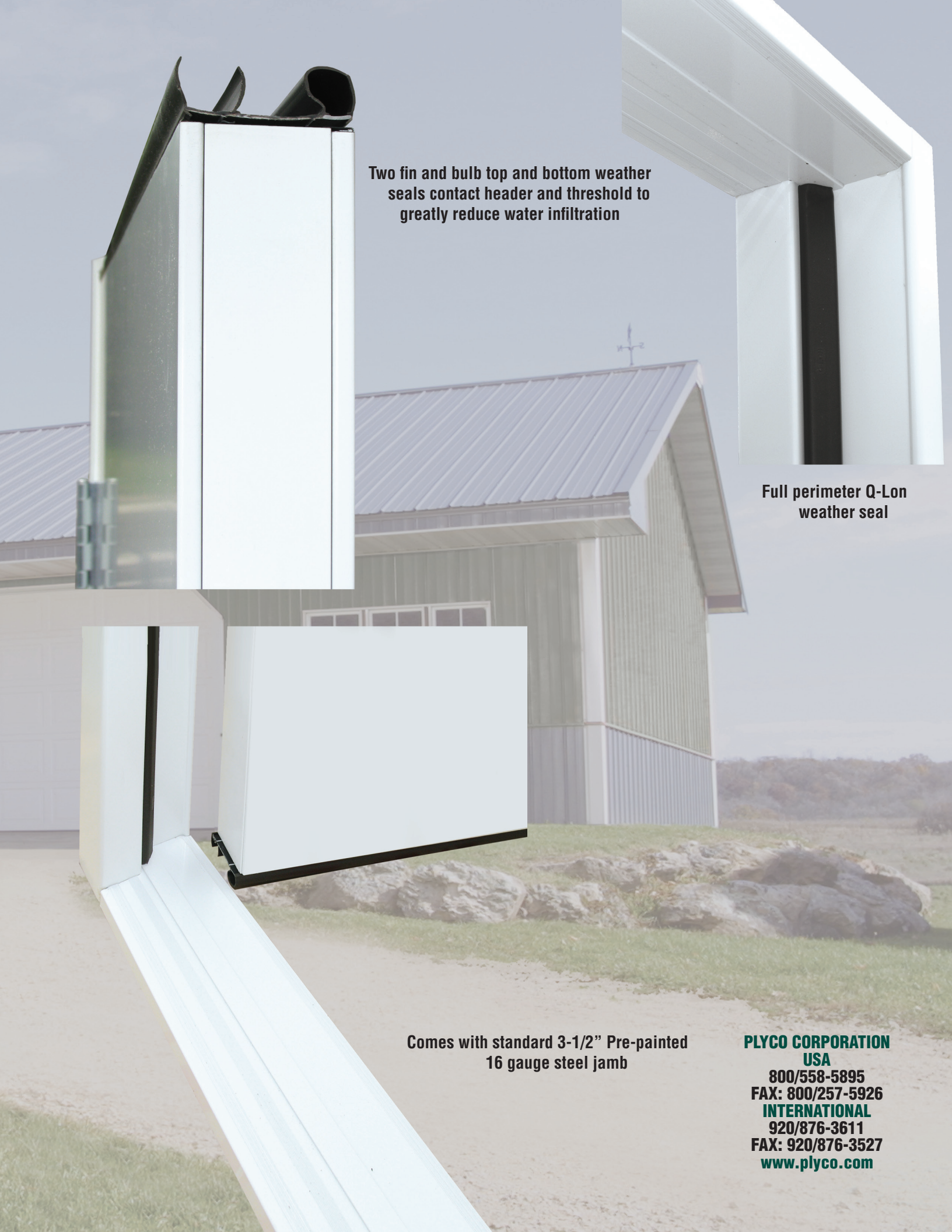

Two fin and bulb top and bottom weather seals contact header and threshold to greatly reduce water infiltration

Full perimeter Q-Lon weather seal

Comes with standard 3-1/2" Pre-painted 16 gauge steel jamb

PLYCO CORPORATION
USA
800/558-5895
FAX: 800/257-5926
INTERNATIONAL
920/876-3611
FAX: 920/876-3527
www.plyco.com

PLYCO Series 95 Door

SIZES	2/4 x 6/8 2/6 x 6/8 2/8 x 6/8 3/0 x 6/8 3/6 x 6/8 4/0 x 6/8 Dbl. 6/0 x 6/8 Dbl. 8/0 x 6/8 3/0 x 7/0 3/6 x 7/0 4/0 x 7/0 Dbl. 6/0 x 7/0 Dbl. 8/0 x 7/0
OVERALL DIMENSIONS	Special sizes are available in picture pane style panels a) For correct out to out dimensions see Data Sheet DO-3 b) For Rough Opening dimensions, use dimensions (above - a) and add 1/2" to width and 3/8" to height.
MULLION / ASTRAGAL	Double doors have attached astragal on the inactive panel of the pair - shipped knocked- down. Hinges are attached to jambs. Manual head and foot bolt concealed in the astragal
HINGES	(3) 4" x 4" zinc plated fixed-pin hinges are standard, SS/NRP available as an option
THRESHOLD	Aluminum

DOOR PANEL

THICKNESS	1 3/4"
SKIN	Smooth 26 ga. Galvanized steel painted finish Polar White
EDGES	Rolled edge in aluminum core rails
BLOCKING	HDPE lock reinforced structure, optional patented heavy duty aluminum closer blocking Special lock blocking is available
INSULATION	Panel R-13 (u=.077)
EMBOSSING	3/0 x 6/8 only - Six panel style
COLORS	Polar White only finish paint
LOCK FACE PREP	Standard with 2 1/8" lockset bore, backset of 2 3/4" (no bore is optional)
DEAD BOLT	Prep is optional, latchguard available as an option
SWEEP	Durable Alcryn Bulb & fin
LITE KITS	1-LI-2 20" x 24" Insulated 1-LA-2 20" x 24" Single glazed 1-LE-2 16" x 16" Insulated 1-LB-2 22" x 36" Insulated 1-LU-2 4" x 48" Single glazed 9-LB-2 22" x 36" Insulated with 9-Lite internal grids Other glass sized available - lite kits listed above are most common

JAMB

TYPE	PREHUNG
MATERIAL	16 ga Steel
FEATURES	Q-Lon Weather Seal
FLASHING	N/A
HINGE REINFORCEMENT	N/A
THERMAL BREAK	N/A

Because of its ongoing commitment to product improvement, Plyco Corporation reserves the right to change, without notice, product specifications, availability, prices and conditions of sale.



www.plyco.com 800/558-5895 FAX: 800/257-5926
INTERNATIONAL 920/876-3611 FAX: 920/876-3527

**WINDOWS • WALK DOORS • WALL VENTS • RIDGE VENTS
SLIDING DOOR TRACK • SLIDE DOOR RAILS • PLY-FOIL INSULATION
HORSE STALLS • FASTENERS & CLOSURES • SPECIALTY PRODUCTS**



TIOGA KNOCK DOWN DOOR SYSTEMS



**WIND RATED / FLORIDA
APPROVED**

MADE IN USA

TELL DOORS & WINDOWS — Page 1 — 2014

CORPORATE OFFICE: 2505 W. 11th Street, Houston, TX 77008 **TOLL FREE:** 877-956-2725 **PHONE:** 713-956-2725 **FAX:** 713-683-8695
OTHER LOCATIONS: BIRMINGHAM, ALABAMA MIRA LOMA, CALIFORNIA ELKHART, INDIANA LITITZ, PENNSYLVANIA DALLAS, TEXAS
WEBSITE: www.tellmfg.com



Tell

DOORS & WINDOWS, LLC.

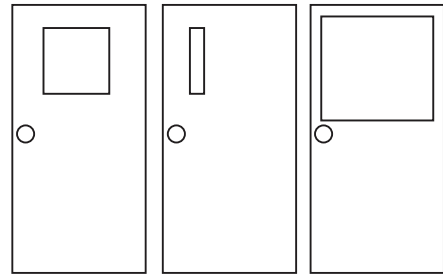

TIOGA KNOCK DOWN OEM DOOR



MADE IN USA

TIOGA DOORS

TELL MFG offers a complete line of standard hollow metal doors to fit your needs. Doors are available in 20 and 18 gauge steel. All doors come with a polystyrene core as standard, making every door smoother, flatter, and stronger. All door panels are manufactured from high quality galvanized steel and are thoroughly cleaned inside and out to insure excellent corrosion resistance and paint adhesion. Doors come standard with a prime coat white or bronze, ready to be finished. Factory applied finish coat paint is available in many colors. Contact customer service for pricing and quantities required, for factory finish paint.

TELL MFG follows the same set of performance specifications as other door manufacturers, as set forth in the Steel Door Institute (SDI) requirements.

- Insulated with polystyrene core
- Non-handed
- Galvanized (standard)
- Fire rated up to 3 hours
- 7 gauge hinge reinforcements
- Reinforced 161 lock prep
- Closer reinforcement (standard)
- Meets ANSI standards
- Universal 4 ½" hinge prep
- Inverted top and bottom channel
- Installed steel cap standard
- Available with polyurethane core

TELL DOORS & WINDOWS — Page 2 — 2014



TIOGA OEM KNOCK DOWN FRAME

TELL MFG offers in 16 gauge galvanized steel. Frames are knock-down construction. **FRAMES** are available for 1 3/4" thick doors as standard. Precision bolted corners provide a smooth attractive design and allow easy installation. **FRAMES** come standard with a prime coat ready to be finished white or bronze. Factory applied finish coat paint is available in many colors. Contact customer service for pricing and quantities required, for factory finish paint.

STANDARD FEATURES:

- 16 gauge for 1-3/4" doors
- Precision bolted corners
- Galvanized (standard)
- 7 gauge hinge reinforcements
- Heavy duty strike reinforcements
- Meets ANSI standards
- Universal 4 1/2" hinge prep

METAL BUILDING FRAMES

- Single Swing Frames / Non-Handed
- Pedestrian Door Frame Head
- Pedestrian Door Frame Hinge Jamb
- Pedestrian Door Frame Strike Jamb
- Sill Section
- Head to Girt Clip and Screw Pack
- K.D. Frame Assembly Details

STOCK PROFILE

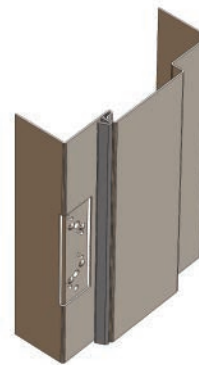
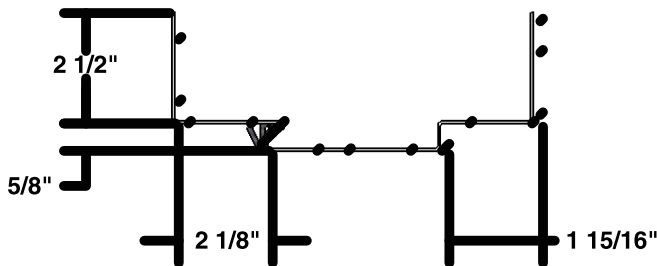

**HINGE
REINFORCEMENT**

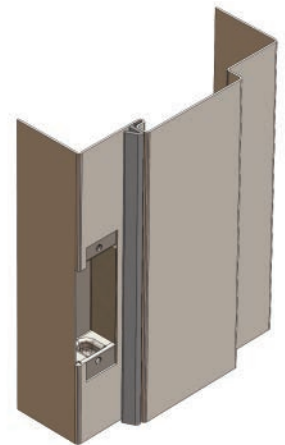

**STRIKE
REINFORCEMENT**

TYPICAL BASE AND WALL ANCHORS





8-1/4" DEPTH KERFED

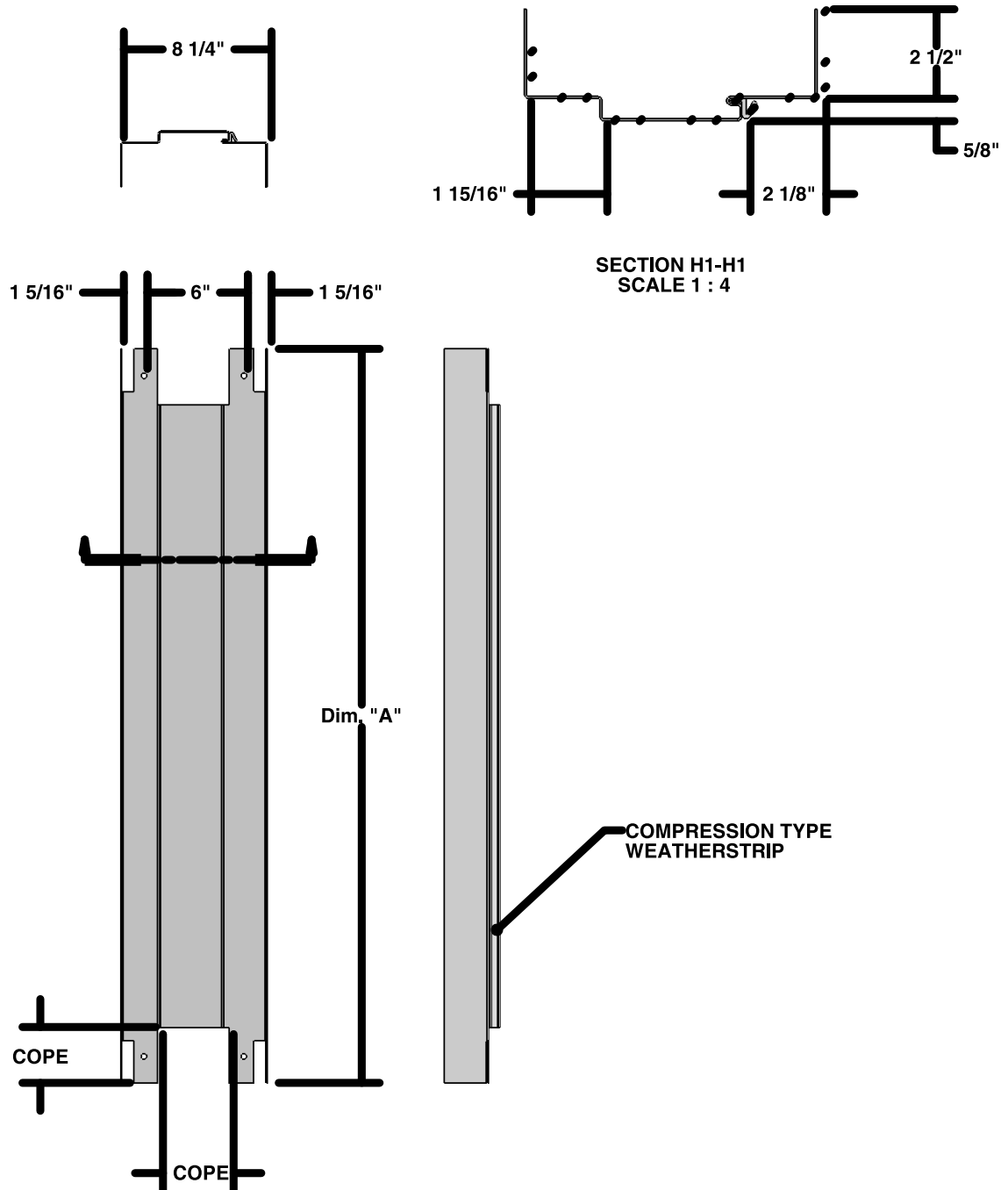



8-1/4" DEPTH KERFED

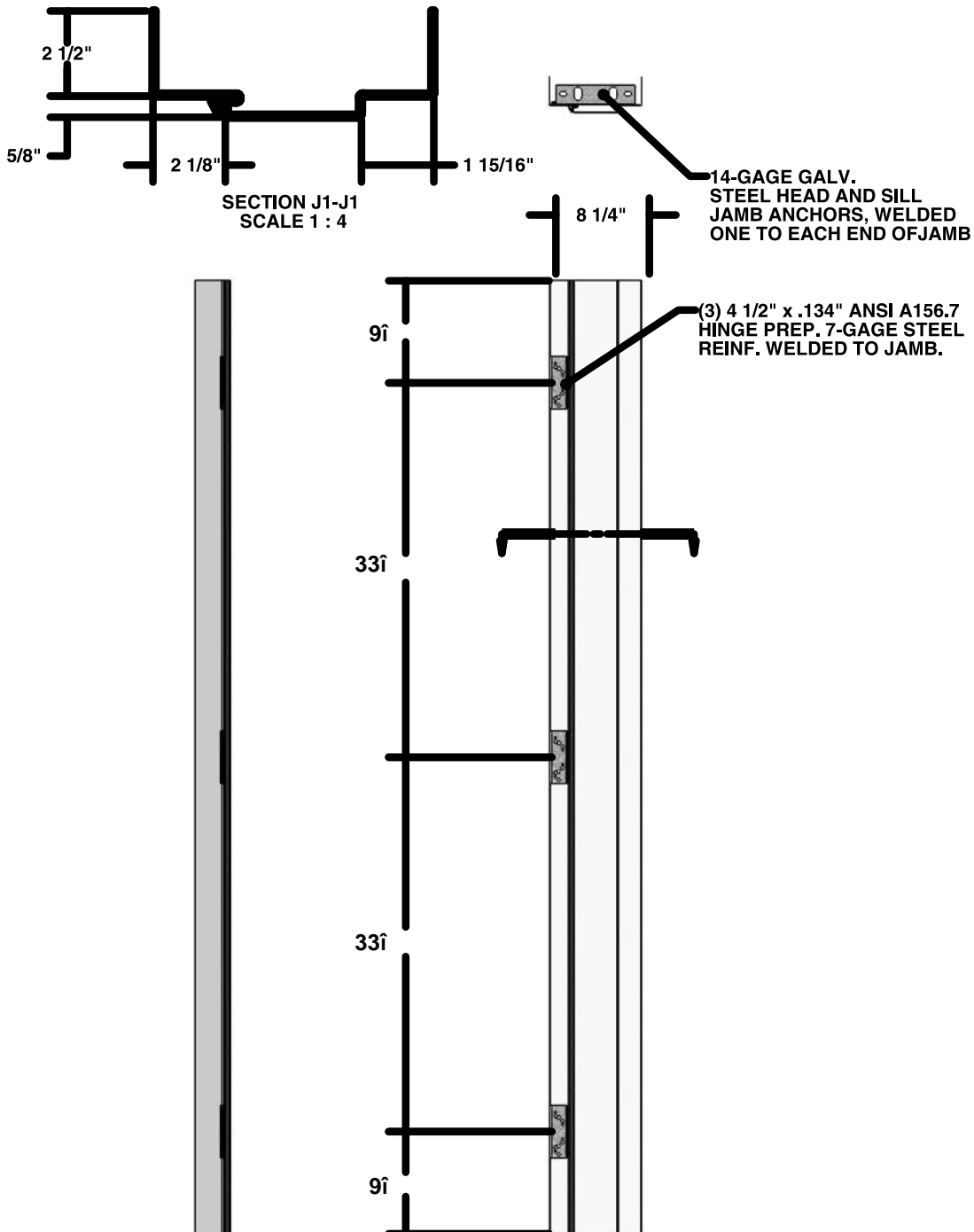

8-1/4" DEPTH KERFED

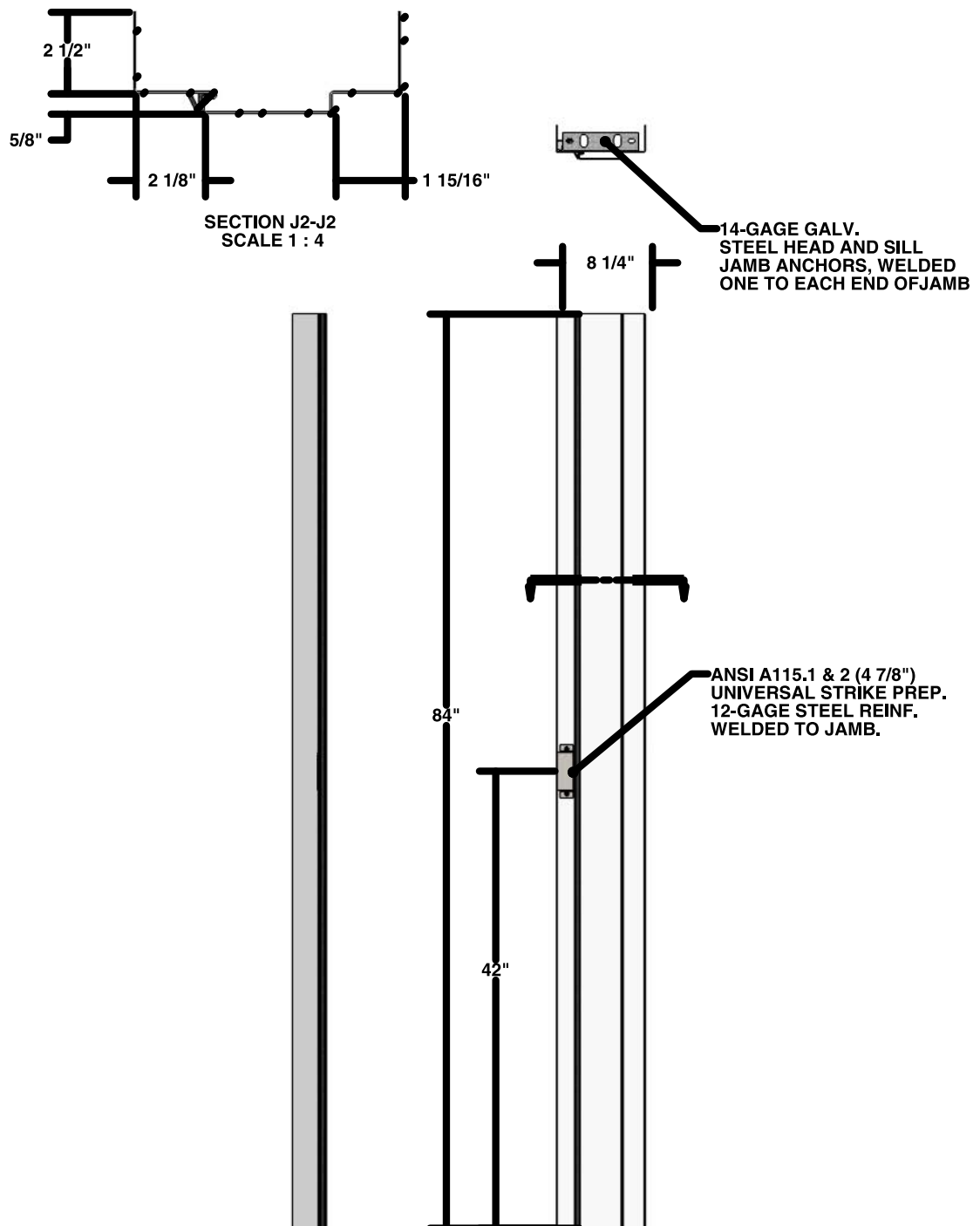

WIND RATED CERTIFICATION, FL APPROVAL # / WIND RATED ~ SINGLE

FL #	MODEL, NUMBER OR NAME	DESCRIPTION
13889.4	TIOGA DOORWAY SYSTEM	TIOGA DOORWAY SYSTEM TDS-S-PA-WS OS STEEL SINGLE DOOR
Limits of Use:		Installation Instructions:
Approved for use in HVHZ: Yes		FL13889 R0 II 08-01021.PDF
Approved for use outside HVHZ: Yes		Verified By: Luis Roberto Lomas 62514
Impact Resistant: Yes		Created by Independent Third Party: Yes
Design Pressure: +50/-50		Evaluation Reports:
Other: PRODUCT WAS NOT TESTED FOR WATER PENETRATION AND IS TO BE INSTALLED IN AREAS WHERE WATER RESISTANCE IS NOT REQUIRED		FL13889 R0 AE 511586.PDF FL13889 R0 AE FOAM CERTIFICATE.PDF
		Created by Independent Third Party: Yes

TIOGA™ DOORWAY SYSTEMS - SINGLE- WINDSTORM ASSEMBLIES (TDS-S-WS)

THE FOLLOWING DOOR, FRAME AND HARDWARE SYSTEMS ARE DESIGNED TO MEET THE REQUIREMENTS OF:

- TAS 201, IMPACT TEST PROCEDURES
- TAS 202, CRITERIA FOR TESTING IMPACT & NON-IMPACT RESISTANT BUILDING ENVELOPE COMPONENTS USING UNIFORM STATIC AIR PRESSURE
- TAS 203, CRITERIA FOR TESTING PRODUCTS SUBJECT TO CYCLIC WIND PRESSURE LOADING

LIMITS OF USE

APPROVED FOR USE IN HVHZ: YES
 APPROVED FOR USE OUTSIDE HVHZ: YES
 IMPACT RESISTANT: YES
 DESIGN PRESSURE: +50/-50 PSF
 OTHER: NONE

SAMPLE: 0A (TDS-S-KD-A-WS)

TIOGA DOORWAY SYSTEM - SINGLE - WINDSTORM ASSEMBLY

- KNOCK-DOWN (KD) SYSTEM
- HARDWARE SET A**
 - 1 CYLINDRICAL LOCK LC1200 SERIES, TELL MFG., INC.
 - 3 HINGES, H4545BBNRP, TELL MFG., INC.
 - 1 THRESHOLD, 1/2" HIGH ALUMINUM
 - 1 SET KERF WEATHERSTRIPPING
 - 1 DOOR SWEEP, DT100101, TELL MFG., INC.

SAMPLE: 0B (TDS-S-KD-B-WS)

TIOGA DOORWAY SYSTEM - SINGLE - WINDSTORM ASSEMBLY

- KNOCK-DOWN (KD) SYSTEM
- HARDWARE SET B**
 - 1 MORTISE LOCK, ML1300 SERIES, TELL MFG., INC.
 - 3 HINGES, H4545BBNRP, TELL MFG., INC.
 - 1 THRESHOLD, 1/2" HIGH ALUMINUM
 - 1 SET KERF WEATHERSTRIPPING
 - 1 DOOR SWEEP, DT100101, TELL MFG., INC.

SAMPLE: 0C (TDS-S-KD-C-WS)

TIOGA DOORWAY SYSTEM - SINGLE - WINDSTORM ASSEMBLY

- KNOCK-DOWN (KD) SYSTEM
- HARDWARE SET C**
 - 1 RIM PANIC DEVICE, 9500 SERIES, TELL MFG., INC.
 - 3 HINGES, H4545BBNRP, TELL MFG., INC.
 - 1 THRESHOLD, 1/2" HIGH ALUMINUM
 - 1 SET KERF WEATHERSTRIPPING
 - 1 DOOR SWEEP, DT100101, TELL MFG., INC.

SAMPLE: 10A (TDS-S-PA-A-WS)

TIOGA DOORWAY SYSTEM - SINGLE - WINDSTORM ASSEMBLY

- PRE-ASSEMBLED (PA) SYSTEM
- HARDWARE SET A**
 - SAME AS 0A

SAMPLE: 10B (TDS-S-PA-B-WS)

TIOGA DOORWAY SYSTEM - SINGLE - WINDSTORM ASSEMBLY

- PRE-ASSEMBLED (PA) SYSTEM
- HARDWARE SET B**
 - SAME AS 0B

SAMPLE: 10C (TDS-S-PA-C-WS)

TIOGA DOORWAY SYSTEM - SINGLE - WINDSTORM ASSEMBLY

- PRE-ASSEMBLED (PA) SYSTEM
- HARDWARE SET C**
 - SAME AS 0C

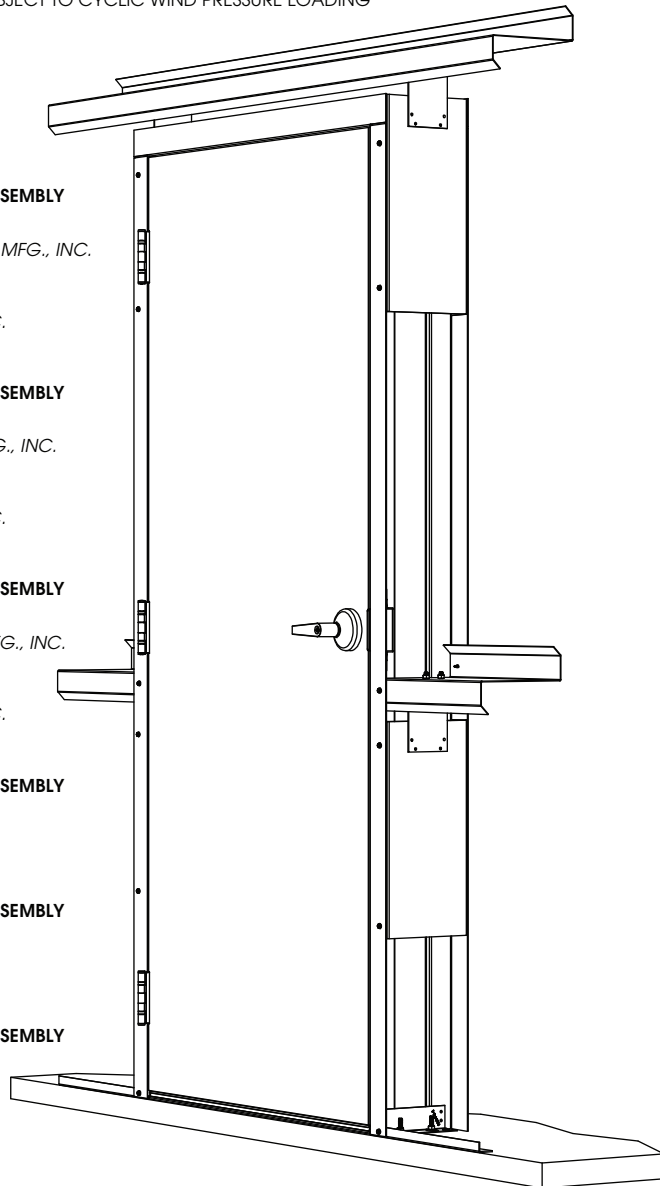

WIND RATED CERTIFICATION, FL APPROVAL # / WIND RATED ~ DOUBLE

FL #	MODEL, NUMBER OR NAME	DESCRIPTION
13889.2	TIOGA DOORWAY SYSTEM	TIOGA DOORWAY SYSTEM TDS-D-PA-WS OS STEEL DOUBLE DOOR
Limits of Use: Approved for use in HVHZ: Yes Approved for use outside HVHZ: Yes Impact Resistant: Yes Design Pressure: +50/-50 Other: PRODUCT WAS NOT TESTED FOR WATER PENETRATION AND IS TO BE INSTALLED IN AREAS WHERE WATER RESISTANCE IS NOT REQUIRED		Installation Instructions: FL13889 R0 II 08-01019.PDF Verified By: Luis Roberto Lomas 62514 Created by Independent Third Party: Yes Evaluation Reports: FL13889 R0 AE 511584.PDF FL13889 R0 AE FOAM CERTIFICATE.PDF Created by Independent Third Party: Yes

TIOGA™ DOORWAY SYSTEMS - DOUBLE- WINDSTORM ASSEMBLIES (TDS-D-WS)

THE FOLLOWING DOOR, FRAME AND HARDWARE SYSTEMS ARE DESIGNED TO MEET THE REQUIREMENTS OF:

- TAS 201, IMPACT TEST PROCEDURES
- TAS 202, CRITERIA FOR TESTING IMPACT & NON-IMPACT RESISTANT BUILDING ENVELOPE COMPONENTS USING UNIFORM STATIC AIR PRESSURE
- TAS 203, CRITERIA FOR TESTING PRODUCTS SUBJECT TO CYCLIC WIND PRESSURE LOADING

LIMITS OF USE

APPROVED FOR USE IN HVHZ: YES
 APPROVED FOR USE OUTSIDE HVHZ: YES
 IMPACT RESISTANT: YES
 DESIGN PRESSURE: +50/-50 PSF
 OTHER: NONE

SAMPLE: 20 (TDS-D-KD-D-WS)

TIOGA DOORWAY SYSTEM - DOUBLE - WINDSTORM ASSEMBLY

- KNOCK-DOWN (KD) FRAME

HARDWARE SET D

- 1 MORTISE LOCK, ML1300 SERIES, TELL MFG., INC.
- 6 HINGES, H4545BBNRP, TELL MFG., INC.
- 1 THRESHOLD, 1/2" HIGH ALUMINUM
- 1 SET KERF WEATHERSTRIPPING
- 2 SURFACE BOLTS, 988Y, YALE SECURITY, INC.
- 2 DOOR SWEEP, DT100101, TELL MFG., INC.
- 1 TWO PIECE STEEL ASTRAGAL / EDGE CHANNEL

SAMPLE: 30 (TDS-D-PA-D-WS)

TIOGA DOORWAY SYSTEM - DOUBLE - WINDSTORM ASSEMBLY

- PRE-ASSEMBLED (PA) UNIT

HARDWARE SET D

- HARDWARE SAME AS 20

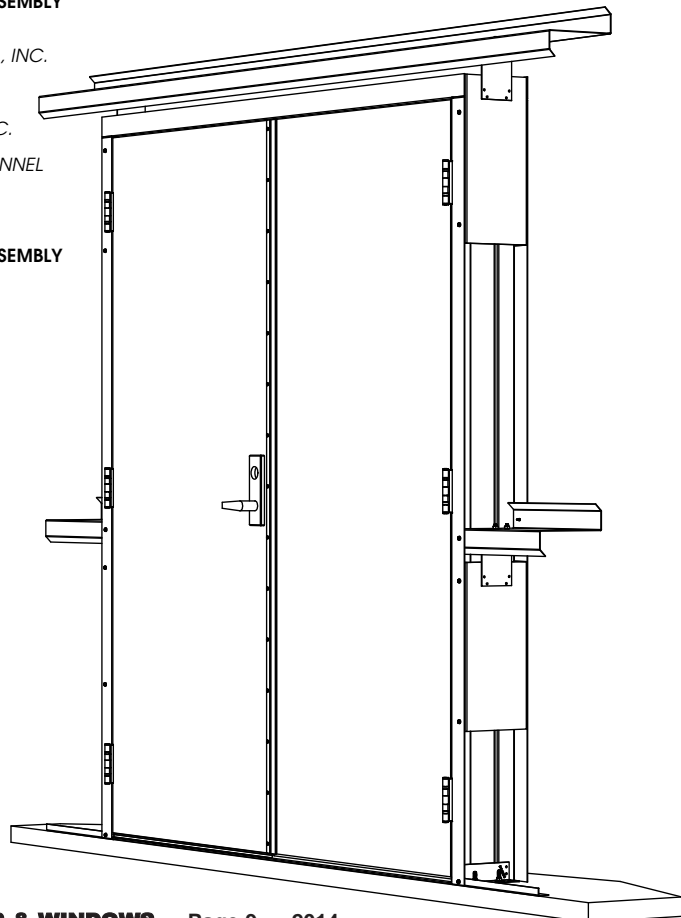

PLYCO...leading the way
to **BETTER** sliding door
systems for farm and
industrial buildings!

PLY-TRAC

Sliding Door Track
and Hardware

- **VERSATILE**
offers you a choice of
mounting brackets for
various applications
- **SAVES INVENTORY \$\$\$**
stock only one track,
and with the option
track brackets, build any
style sliding door

- **Made of Heavy Duty
14 Gauge Steel**

Call our offices for more information 1-800-558-5895

PLYCO
CORPORATION

Elkhart Lake, WI 53020

USA 800-558-5895
INTERNATIONAL 920-876-3611
Fax 800-257-5926 Fax 920-876-3527

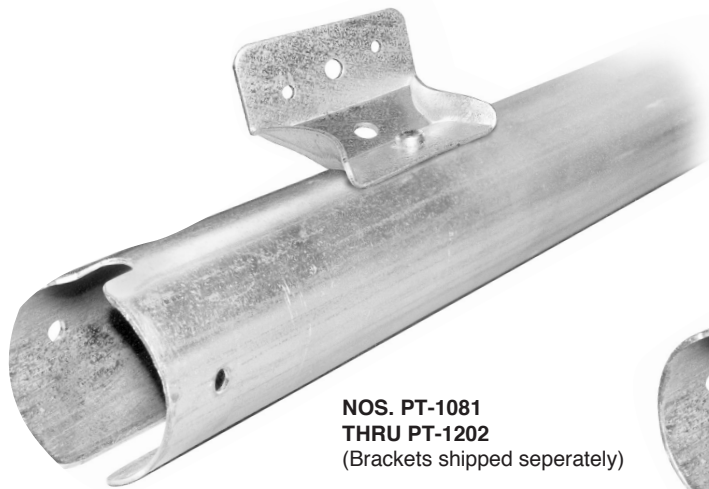

NOS. PT-1081
THRU PT-1202
(Brackets shipped seperately)

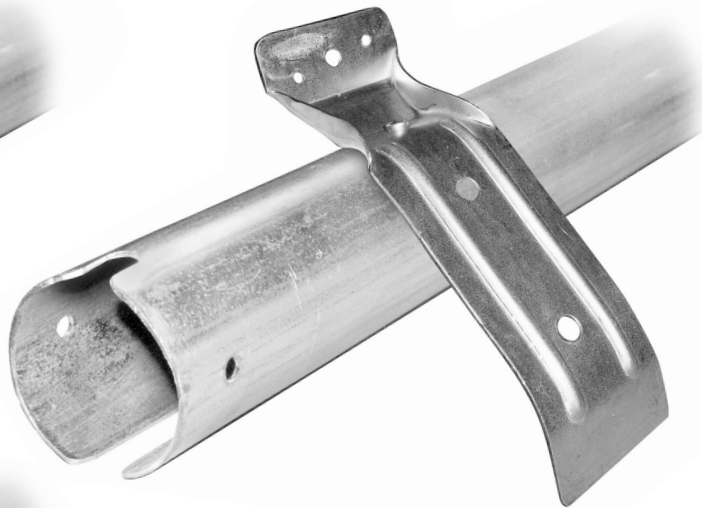

119300

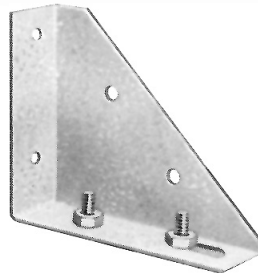

PLY-TRAC ***ACCESSORIES*** ***& HARDWARE***

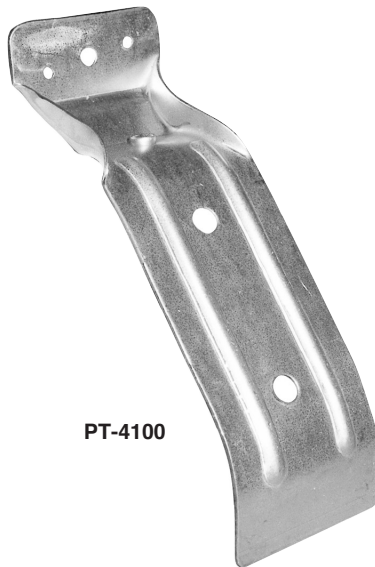

PT-4100

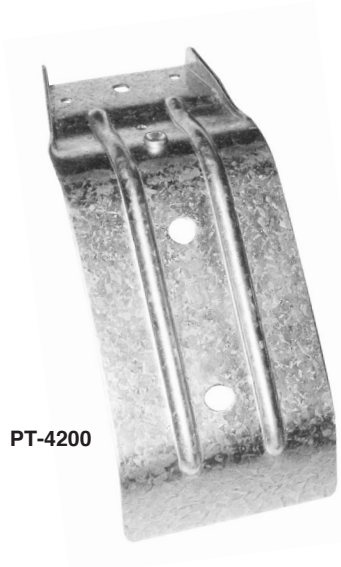

PT-4200



131000

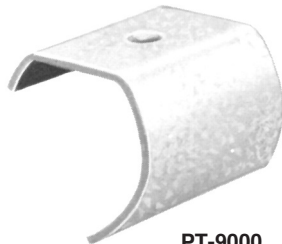

PT-9000



PT-4000



PT-4796

Due to Plyco Corporations on going commitment to product improvement, we reserve the right to change, without notice, product specifications, availability, prices and conditions of sale.

PLYCO

CORPORATION

Elkhart Lake, WI 53020

USA 800-558-5895
INTERNATIONAL 920-876-3611
Fax 800-257-5926 Fax 920-876-3527

Distributed By